Hexagon Pavers Footpath A110.10



DESIGN STATEMENT

The hexagon pavers are Coburg's feature paving. These pavers are custom made to be installed in significant areas and corners feathering into intersecting streets with standard asphalt footpath.

APPLICABLE LOCATION

Coburg Activity Centre as specified by Council.

COUNCIL STANDARD DRAWING

N/A

CROSS REFERENCE DOCUMENT

- Coburg Streetscape Masterplan
- Brunswick Public Realm Design Manual

STANDARD SPECIFICATION

Materials: Granite, flame finish, 400 grit diamond sawn cut
Use a mix of three granite colours to create variations: Feline (light grey) (15% of total area), Barramundi (mid grey) (30% of total paved area) and bluestone (45% of total paved area).

Dimension: 395mm wide (measured on the diagonal)

Pedestrian /non-trafficable area: 60mm thick

Vehicle/trafficable area: 125mm thick

Refer also to drawing for the base thickness for pedestrian and vehicle areas.

Other: Pavers to be laid from Back of Kerb and neatly cut at building line and where required to suit shape of service fittings and other existing features.

SUPPLIER

Eigen Stone or Council approved equivalent.

MAINTENANCE

Road Maintenance Unit: Replace sections of concrete pavers when damaged, between nearest joints, patching of small areas is not allowed. All new replaced concrete sections to be dowelled.

Street Cleansing Unit: Cleaning will be undertaken as per current schedule.

GENERAL NOTE

1. N/A

A110.10 Hexagon Pavers Footpath

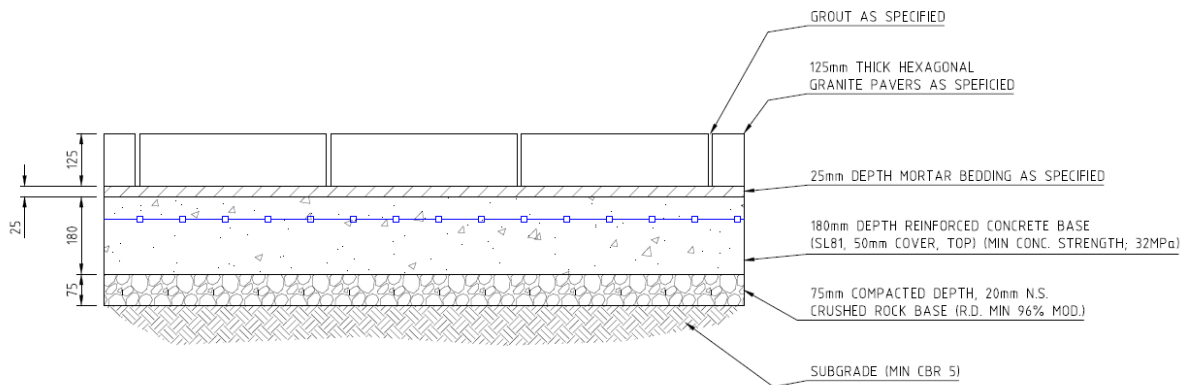

VEHICLE TRAFFICABLE PAVEMENT
NOT TO SCALE

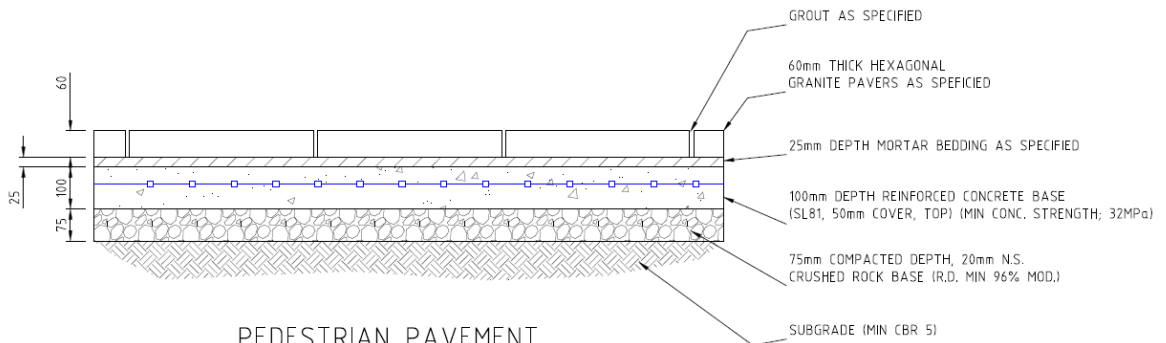

PEDESTRIAN PAVEMENT
NOT TO SCALE

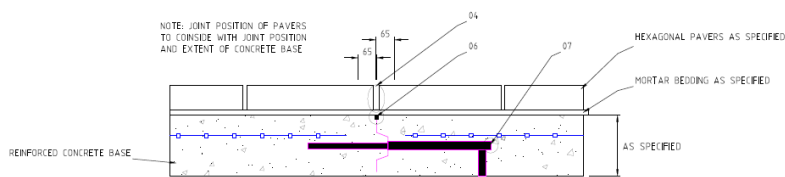

MOVEMENT JOINT
NOT TO SCALE

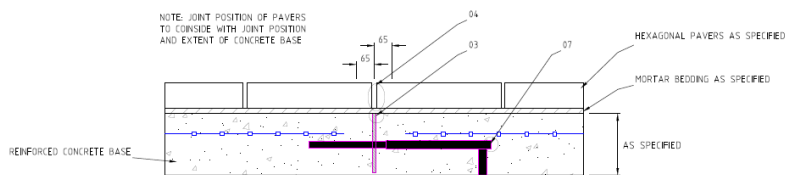

EXPANSION JOINT
NOT TO SCALE