

PLANNING & ENVIRONMENT ACT 1977  
MORELAND PLANNING SCHEME

This plan has been endorsed pursuant to  
Planning Permit ..... 11/12/2014/87.

Signed .....  
For and on behalf of Moreland City Council

Date..... 22/9/14

Sheet ..... of 34

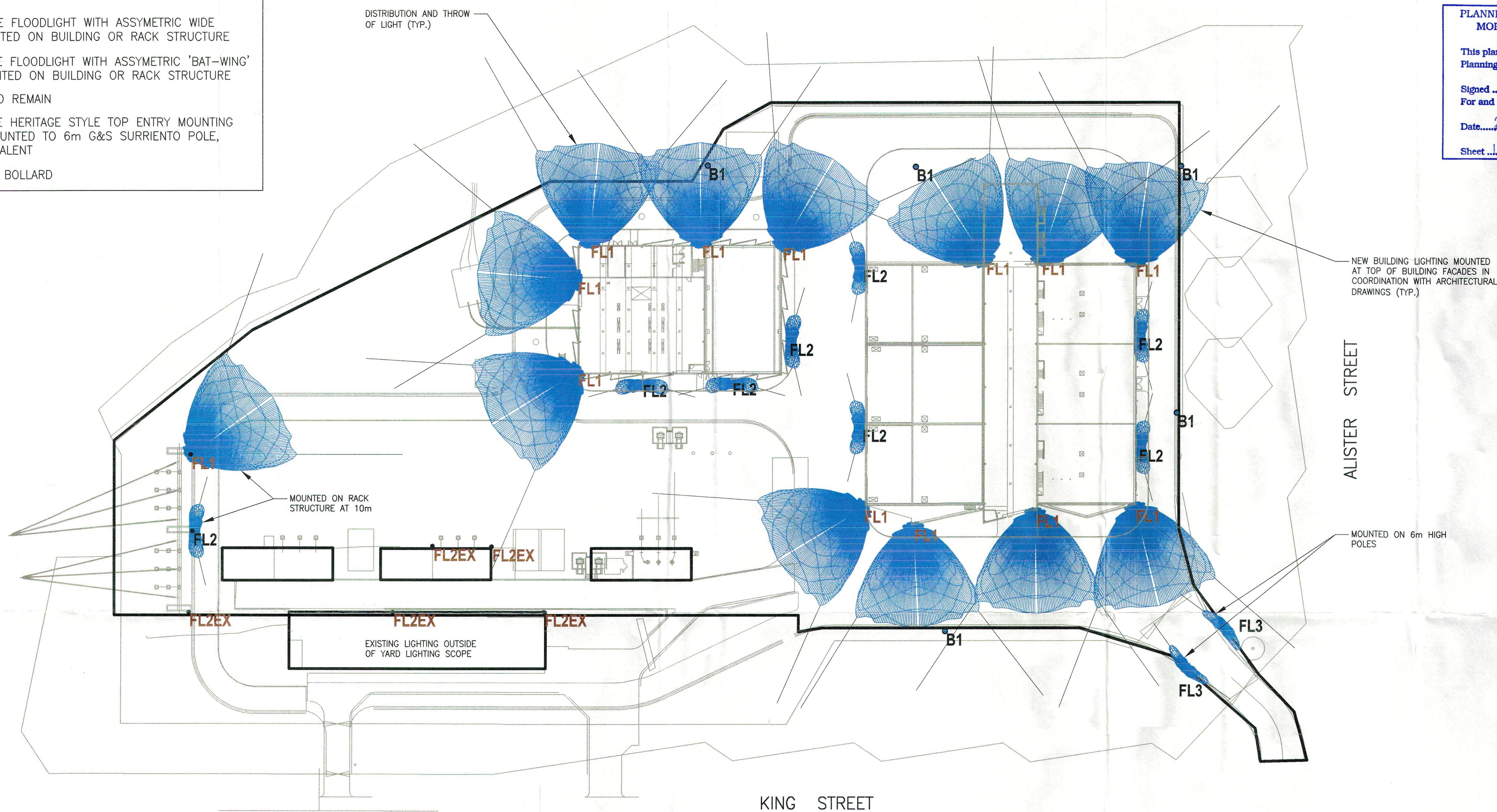

- LIGHTING TO BE DESIGNED AND BAFFLED TO ENSURE NO UNREASONABLE LIGHT SPILL ONTO RESIDENTIAL PROPERTIES IN ACCORDANCE WITH THE RECOMMENDATIONS OF THE RELEVANT AUSTRALIAN STANDARDS AROUND OBTRUSIVE LIGHTING (AS4282).
- LIGHT POLES TO BE MAXIMUM 6m TALL, OF PUBLIC STREET STYLE AND PAINTED BLACK.
- SITE LIGHTING TO CONSIST OF BOLLARD LIGHTING, LIGHTING ON BUILDINGS OR AN ALTERNATIVE TO THE SATISFACTION OF THE RESPONSIBLE AUTHORITY.

PLAN  
SCALE 1:500

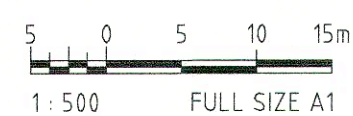

REFERENCE DRAWINGS			REVISION								DRAWN	AECOM	BRUNSWICK TERMINAL STATION EXTERNAL LIGHTING LAYOUT					
											ENDORSED	REV		B				
											ISSUED							
											CONTRACTORS No.							
				09.9.14	B	LEGEND ADDED, ENTRY LIGHTING AMENDED					Z.N.	AECOM		SPEC No.				
				01.8.14	A	FIRST ISSUE					E.S.	AECOM		ORDER No.				
						DATE	REV	DESCRIPTION				BY		CONTRACTOR				
DRAWING TITLE		DRAWING No.													SPI PowerNet No		SK059	B