



Imaged Document Cover Sheet

The document following this cover sheet is an imaged document supplied by LANDATA®, Secure Electronic Registries Victoria.

Document Type	Plan
Document Identification	TP710929P
Number of Pages (excluding this cover sheet)	1
Document Assembled	26/06/2023 15:22

Copyright and disclaimer notice:

© State of Victoria. This publication is copyright. No part may be reproduced by any process except in accordance with the provisions of the Copyright Act 1968 (Cth) and for the purposes of Section 32 of the Sale of Land Act 1962 or pursuant to a written agreement. The information is only valid at the time and in the form obtained from the LANDATA® System. None of the State of Victoria, LANDATA®, Secure Electronic Registries Victoria Pty Ltd (ABN 86 627 986 396) as trustee for the Secure Electronic Registries Victoria Trust (ABN 83 206 746 897) accept responsibility for any subsequent release, publication or reproduction of the information.

The document is invalid if this cover sheet is removed or altered.

TITLE PLAN		EDITION 1	TP 710929P
------------	--	-----------	------------

<p>Location of Land</p> <p>Parish: JIKA JIKA Township: Section: Crown Allotment: Crown Portion:</p> <p>Last Plan Reference: LP7329 Derived From: VOL 9545 FOL 528 Depth Limitation: NIL</p>	<p style="text-align: center;">Notations</p> <p>ANY REFERENCE TO MAP IN THE TEXT MEANS THE DIAGRAM SHOWN ON THIS TITLE PLAN</p>
--	--

<p>Description of Land / Easement Information</p>	<p>THIS PLAN HAS BEEN PREPARED FOR THE LAND REGISTRY, LAND VICTORIA, FOR TITLE DIAGRAM PURPOSES AS PART OF THE LAND TITLES AUTOMATION PROJECT</p> <p>COMPILED: 11/04/2003 VERIFIED: RZ</p>
--	---

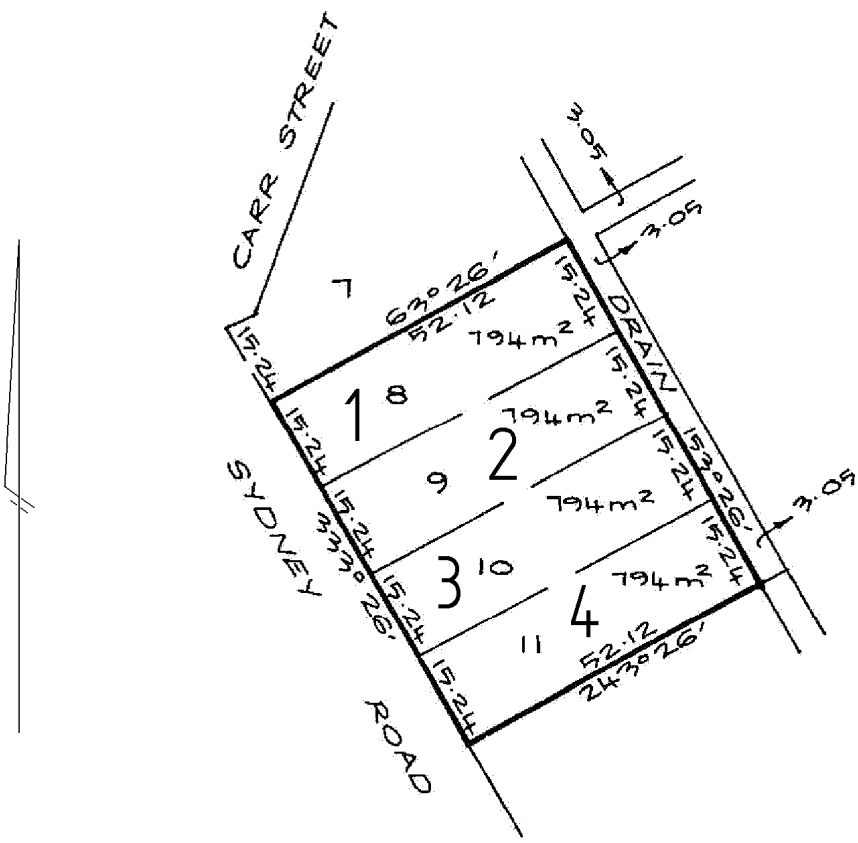

TABLE OF PARCEL IDENTIFIERS
WARNING: Where multiple parcels are referred to or shown on this Title Plan this does not imply separately disposable parcels under Section 8A of the Sale of Land Act 1962
PARCEL 1 = LOT 8 ON LP7329
PARCEL 2 = LOT 9 ON LP7329
PARCEL 3 = LOT 10 ON LP7329
PARCEL 4 = LOT 11 ON LP7329